

LSH (E-2000™)

E-2000™ is a high performance connector which meets the highest standards by excellence in design and manufacturing processes. Only high quality and high precision materials are used to guarantee connections at the highest level. HUBER+SUHNER E-2000™ products meet the international standards IEC 61754-15 and TIA 604-16 and are naturally RoHS compliant.



High performance

The E-2000™ has proven its performance world-wide in CATV and telecommunication networks. Quality and performance are in a class of its own. With a high precision Zirconia full ceramic ferrule an insertion loss of 0.1 dB and an APC return loss of more than 85 dB, E-2000™ is especially suited for installation in global high performance networks.

High reliability

The fully controlled manufacturing processes stand for the incomparably reliability of HUBER+SUHNER E-2000™-products. Not only the connector-production is quality proof; HUBER+SUHNER advances quality and reliability a step further. HUBER+SUHNER E-2000™ connectors are terminated only by certified LAS partners. These local assembly shops have been chosen because of their profound knowledge and ability to meet the highest quality standards.

High safety

In addition to high performance, E-2000™ offers safety and time savings. With its automatic full metal shutters, E-2000™ conforms to the highest safety requirements in all current laser classes. Full metal shutters are essential in high power applications. All optical functional parts are protected against mechanical damage and dust. Easily establish permanent connections by simply removing the lock-up-lever. This prevents any accidental disconnecting and allows easy and safe handling.

High flexibility

HUBER+SUHNER offers a complete range of E-2000™-products that fit every application. The mechanical and colour coding system can be changed both at the connector and at the adapter. This system prevents interconnection errors and saves time during installation and maintenance.

Now, not only single circuit designs can profit from E-2000™'s outstanding features; the newly designed duplex connectors and adapters allow time and space savings.

LSH (E-2000™)

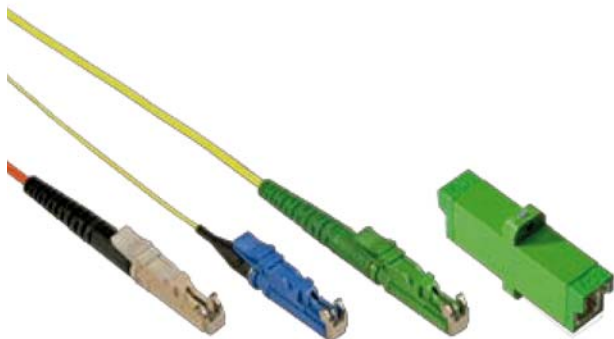

Features

- Latched push-pull connector
- Automatic metal shutter in connector and adapter for dust protection and laser safety
- One-piece design for easy termination
- Colour coding of connector and adapter
- Mechanical coding of connector and adapter
- Ideal for HighPower applications
- Switchable duplex clips

Ordering information: LSH connector, uncoded



Connector type	Polishing	Insertion loss ¹⁾ [dB] (mean/97%)	Cable Ø [mm]	Type
SM	APC	0.12/0.25	≤ 3.5	FLSH-2000-A608
SM ²⁾	APC	0.12/0.25	≤ 3.5	FLSH-2000-A609
SM premium	APC	0.06/0.15	≤ 3.5	FLSH-2000-H600



Connector type	Polishing	Insertion loss ¹⁾ [dB] (mean/97%)	Cable Ø [mm]	Type
SM	PC/UPC	0.12/0.25	≤ 3.5	FLSH-2000-A105
SM premium	PC/UPC	0.06/0.15	≤ 3.5	FLSH-2000-H101



Connector type	Polishing	Insertion loss ¹⁾ [dB] (mean/97%)	Cable Ø [mm]	Type
G50/125, G62.5/125	PC	0.2 / 0.5	≤ 3.5	FLSH-2000-B103
HCS200/230	PC	0.3 / 0.75	≤ 3.5	FLSH-2000-D101

Ordering information: LSH accessories



Type	Material	Packing unit
FLSH-DUP-CLIP	Plastic	100 pieces

1) IEC 61300-3-34 method 2

2) ferrule bore 125.3 ⁺¹/₋₀ µm

LSH (E-2000™)

Ordering information: LSH adapter, uncoded



Adapter type	Mounting	Sleeve material	Colour	Type
compact SM	integrated fixing springs	zirconia ceramic	blue	FLSH-FLSH-A100
compact APC	integrated fixing springs	zirconia ceramic	green	FLSH-FLSH-A600
compact SM HighPower 0.1 dB	integrated fixing springs	zirconia ceramic	blue	FLSH-FLSH-A110
compact SM APC HighPower 0.1 dB	integrated fixing springs	zirconia ceramic	green	FLSH-FLSH-A610
compact MM	integrated fixing springs	zirconia ceramic	beige	FLSH-FLSH-A101



Adapter type	Mounting	Sleeve material	Colour	Type
SM	with 2-hole flange	zirconia ceramic	blue	FLSH-FLSH-D100
SM APC	with 2-hole flange	zirconia ceramic	green	FLSH-FLSH-D600
SM HighPower 0.1 dB	with 2-hole flange	zirconia ceramic	blue	FLSH-FLSH-D110
SM APC HighPower 0.1 dB	with 2-hole flange	zirconia ceramic	green	FLSH-FLSH-D610
MM	with 2-hole flange	zirconia ceramic	beige	FLSH-FLSH-D102



Adapter type	Mounting	Sleeve material	Colour	Type
SM	integrated fixing springs	zirconia ceramic	blue	FLSH-FLSH-A100-02
SM APC	integrated fixing springs	zirconia ceramic	green	FLSH-FLSH-A600-02
SM HighPower 0.1 dB	integrated fixing springs	zirconia ceramic	blue	FLSH-FLSH-A110-02
SM APC HighPower 0.1 dB	integrated fixing springs	zirconia ceramic	green	FLSH-FLSH-A610-02
MM	integrated fixing springs	zirconia ceramic	beige	FLSH-FLSH-A101-02

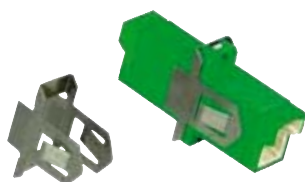

Ordering information: LSH accessories

Quick-mounting spring	Material	Type
100 pieces	metal	ACC-FIX-001

- easy snap-in mounting

E-2000™ is manufactured under licence of DIAMOND SA, CH LOSONE

LSH (E-2000™)

Specifications

Compliance	IEC 61754-15, TIA 604-16		
Technology	full ceramic ferrule (2.5 mm) and sleeve		
Tuning	in 60° steps		
Mechanical resistance	100 N tensile load		
Operating temperature	-40 °C to +85 °C		
Flammability	UL 94 V-0		
Durability	min. 1000 mating cycles		
Colour of housing	singlemode	PC	blue
	singlemode	APC	green
	multimode		beige

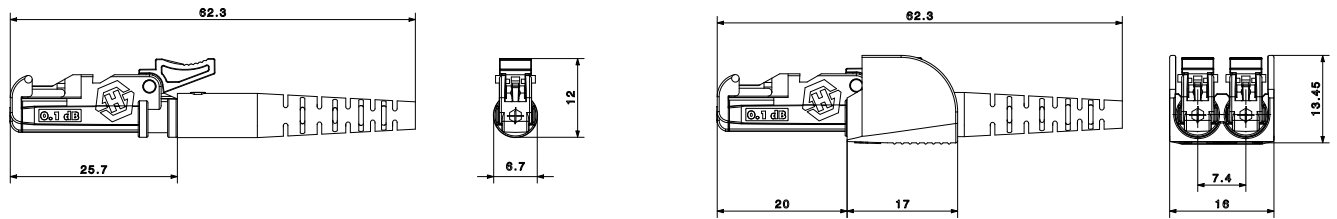

Simplex adapter with integrated fixing springs

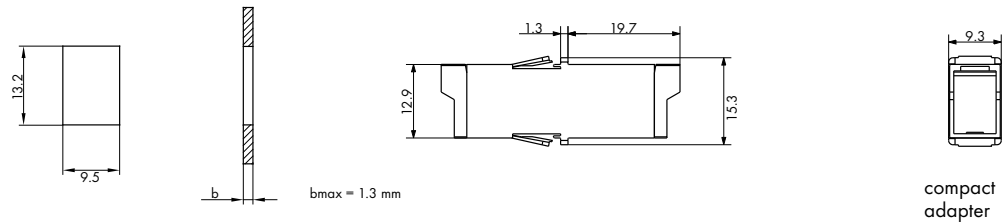

Simplex adapter with 2-hole flange

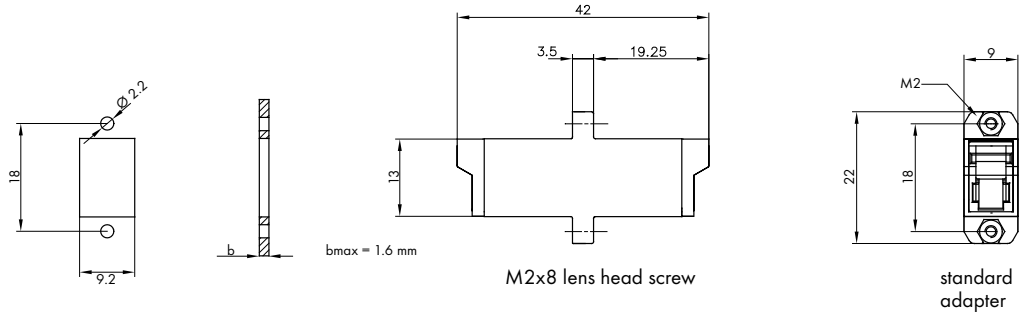

Duplex adapter with integrated fixing springs

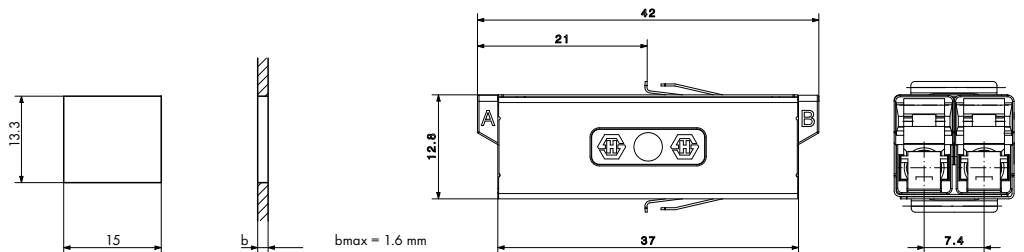

LSH (E-2000™)

Mechanical coding system

The mechanical and colour coding system allows fast and secure installation of connectors and adapters, ensuring mating without risk of confusion. Connectors and adapters without coding are still available and fit on any coded piece.

Ordering information

Type		
FLSH-FLSH-D600-A	adapter code	
0	uncoded	same colour as adapter
1	red	coded
2	brown	coded
3	yellow	coded
4	orange	coded
5	purple	coded
6	white	coded
A	red	uncoded
B	brown	uncoded
C	yellow	uncoded
D	orange	uncoded
E	purple	uncoded
F	white	uncoded
G	green	uncoded
H	blue	uncoded
I	black	uncoded
J	grey	uncoded
K	pink	uncoded
L	turquoise	uncoded

Type		
FLSH-2000-A101-C	connector code	
1	red	coded
2	brown	coded
3	yellow	coded
4	orange	coded
5	purple	coded
6	white	coded
A	red	uncoded
B	brown	uncoded
C	yellow	uncoded
D	orange	uncoded
E	purple	uncoded
F	white	uncoded
G	green	uncoded
H	blue	uncoded
I	black	uncoded
J	grey	uncoded
K	pink	uncoded
L	turquoise	uncoded

Examples:

FLSH-FLSH-D600-A14 – green adapter + red coding frame on frontside, orange coding frame on backside

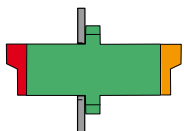

FLSH-FLSH-D600 – green adapter without coding

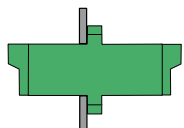

FLSH-2000-A101-C1 – blue connector + red coding



FLSH-2000-A101 – blue connector without coding



E-2000™ is manufactured under licence of DIAMOND SA, CH LOSONE