

4

3

2

1

DATE	REV	ECN	APP'D. BY
03/15/19	A0	Released	GWL

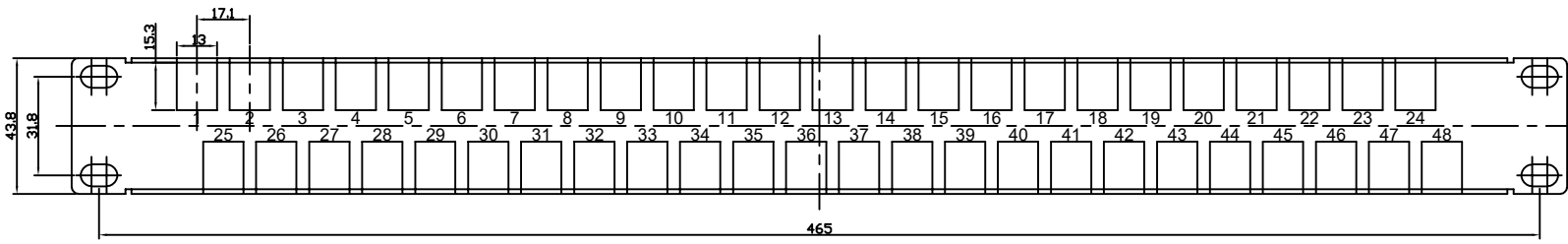
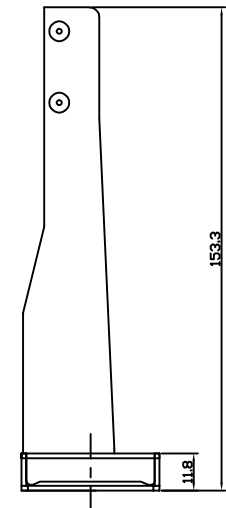
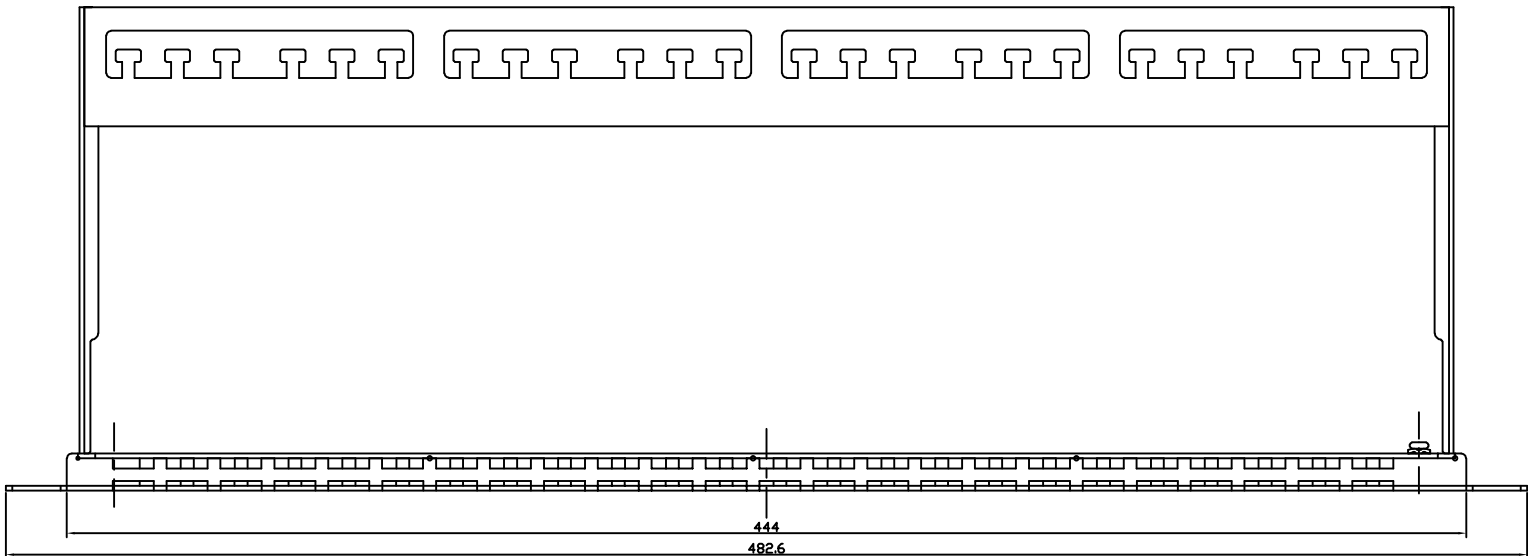
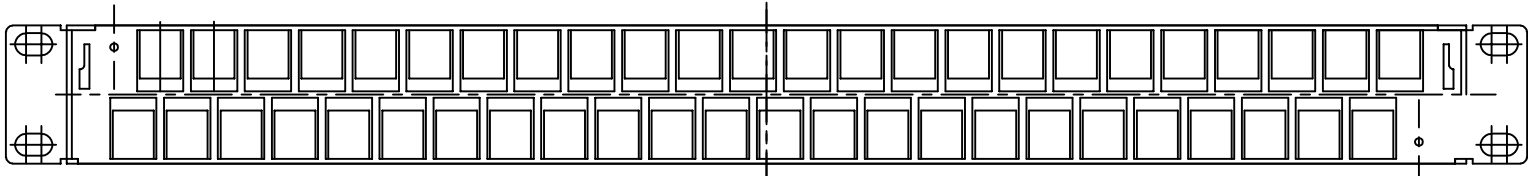

ASY82120-005  
PART NUMBER

**NOTES:**

1. WIRE RACK MATERIAL: STAINLESS STEEL, NICKEL COATING
2. BACK COVER MATERIAL: STAINLESS: BLACK COATING
3. FRONT PANEL: ABS 94V0 PLASTIC



THIRD ANGLE PROJECTION			206 Van Vorst Street Jersey City, NJ 07302 +1 201 432 0463 <a href="http://www.belfuse.com">http://www.belfuse.com</a>	
			<b>TITLE:</b> <b>PATCH PANEL 1 48 PORTS SNAP-IN, PANEL FOR CAT6 AND CAT6A</b>	
DO NOT SCALE DRAWING DRAWING IS SUBJECT TO CHANGE WITHOUT NOTICE		DRN BY: BTS      DATE: 03/15/19 APPD BY: GWL      DATE: 03/15/19		
DIMENSIONS: METRIC		DWG NO. CT820031      REV. A0		
UNLESS OTHERWISE SPECIFIED TOLERANCES ARE ±0.2 ANGLES ARE ± 1°		THIS DRAWING AND THE SUBJECT MATTER SHOWN THEREON ARE CONFIDENTIAL AND THE PROPRIETARY PROPERTY OF BEL FUSE, INC. AND SHALL NOT BE REPRODUCED, COPIED, OR USED IN ANY MANNER WITHOUT PRIOR WRITTEN CONSENT OF BEL FUSE, INC.		
SHEET NO. 1 OF 1				